



TOWN CENTER PROJECT GROUND FLOOR

FLOOR	TITLE	UNIT	AREA
GROUND FLOOR	HYPER MARKET	1	3178.00 Sq.m
GROUND FLOOR	RESTAURANT	16	3444.00 Sq.m
GROUND FLOOR	RETAIL	24	3096.00 Sq.m
TOTEL GROUND FLOOR AREA-			9718.00 Sq.m

LOFT REAL ESTATE
MOB : +966552419045
Email: m.ali@loft.com.sa



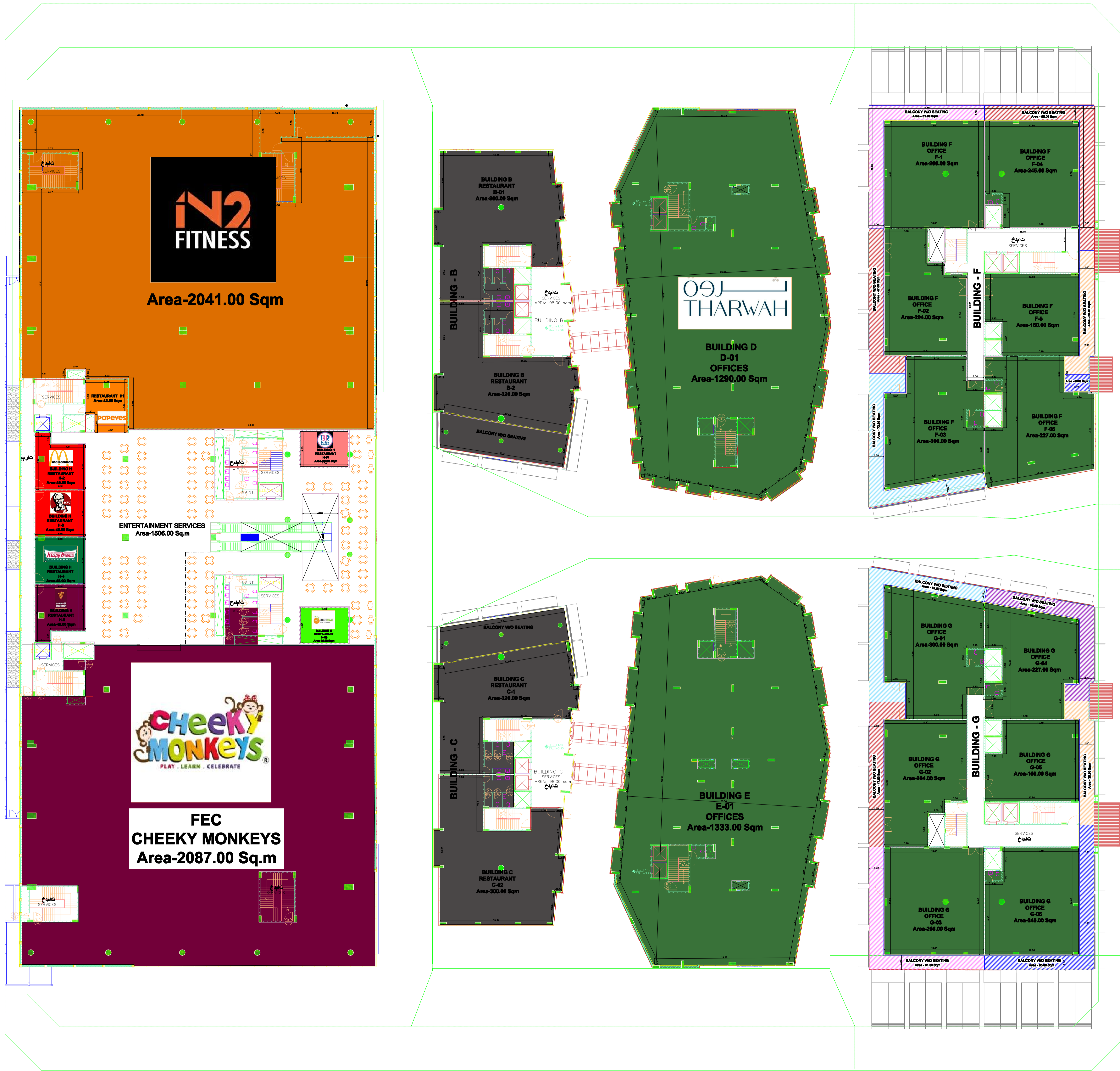

TOWN CENTER PROJECT FIRST FLOOR

FLOOR	TITLE	UNIT	AREA
FIRST FLOOR	CENEMA	01	2041.00 Sq.m
FIRST FLOOR	ENTERTAINMENT	01	2087.00 Sq.m
FIRST FLOOR	FOOD COURT	07	302.00 Sq.m
FIRST FLOOR	RESTAURANT	04	1240.00 Sq.m
FIRST FLOOR	OFFICE'S	14	6470.00 Sq.m
TOTEL FIRST FLOOR AREA-			11140.00 Sq.m

LOFT REAL ESTATE
MOB : +966552419045
Email: m.ali@loft.com.sa



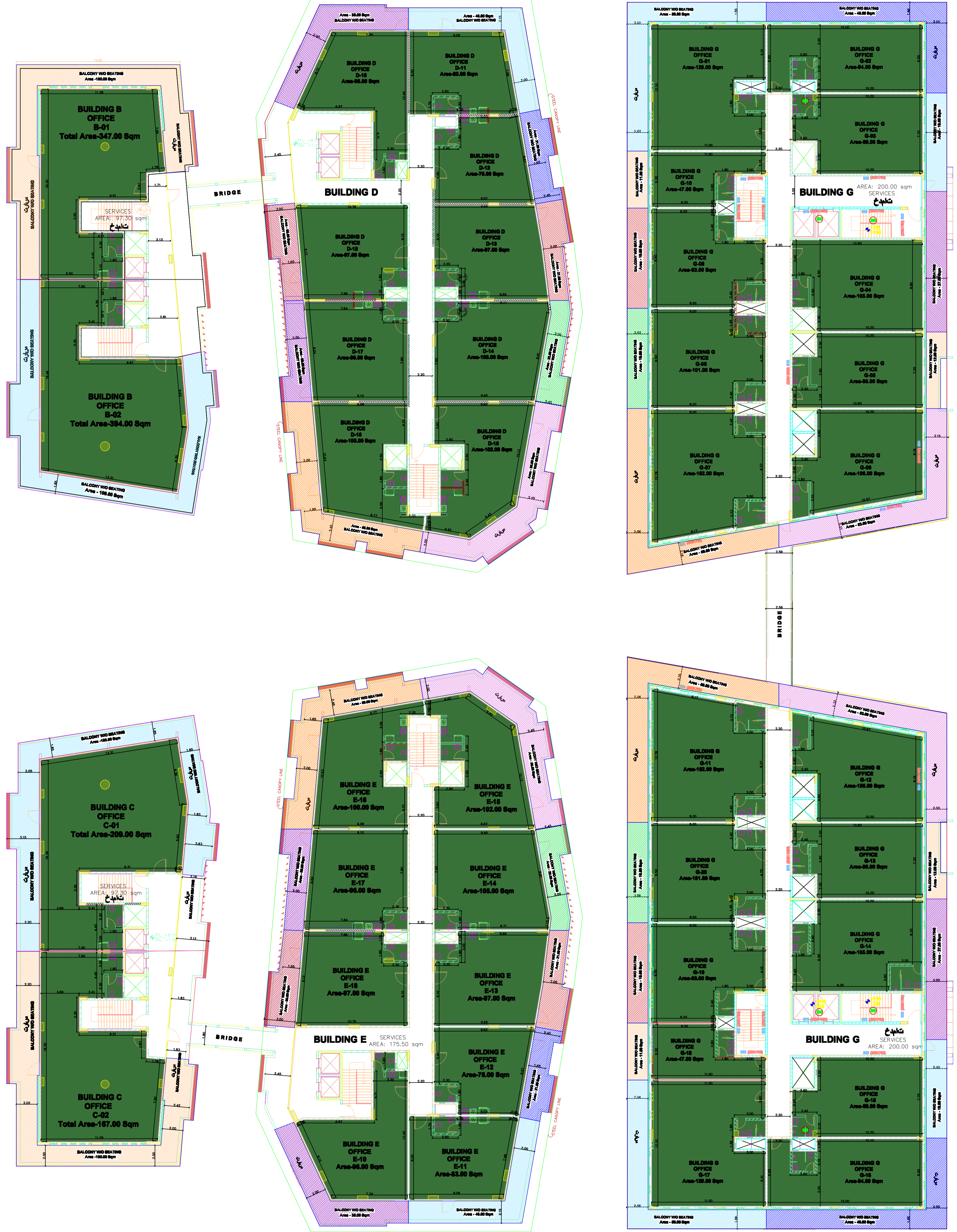
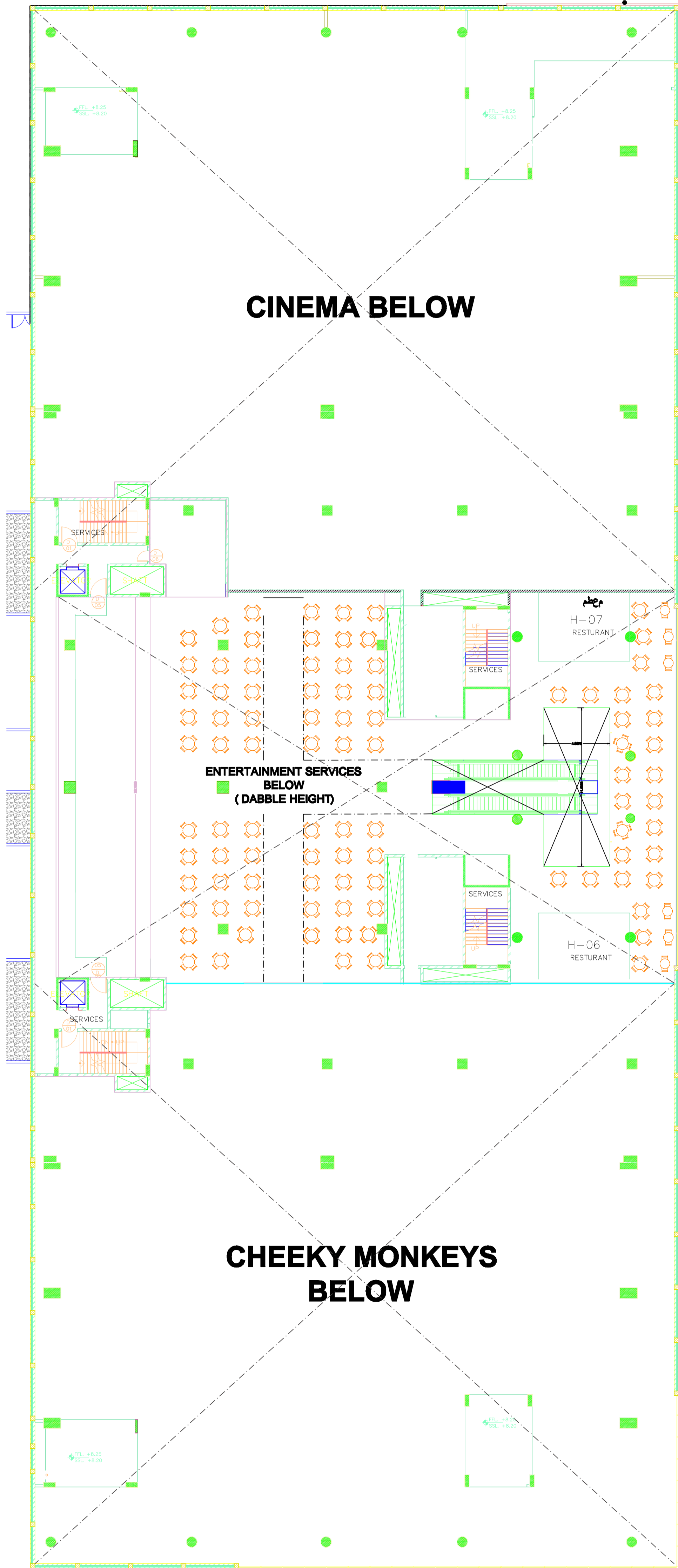

TOWN CENTER PROJECT THIRD FLOOR

FLOOR	TITLE	UNIT	AREA
SECOND FLOOR	OFFICE'S	42	5208.00 Sq.m
TOTAL THIRD FLOOR AREA-			5208.00 Sq.m

LOFT REAL ESTATE
MOB : +966552419045
Email: m.ali@loft.com.sa



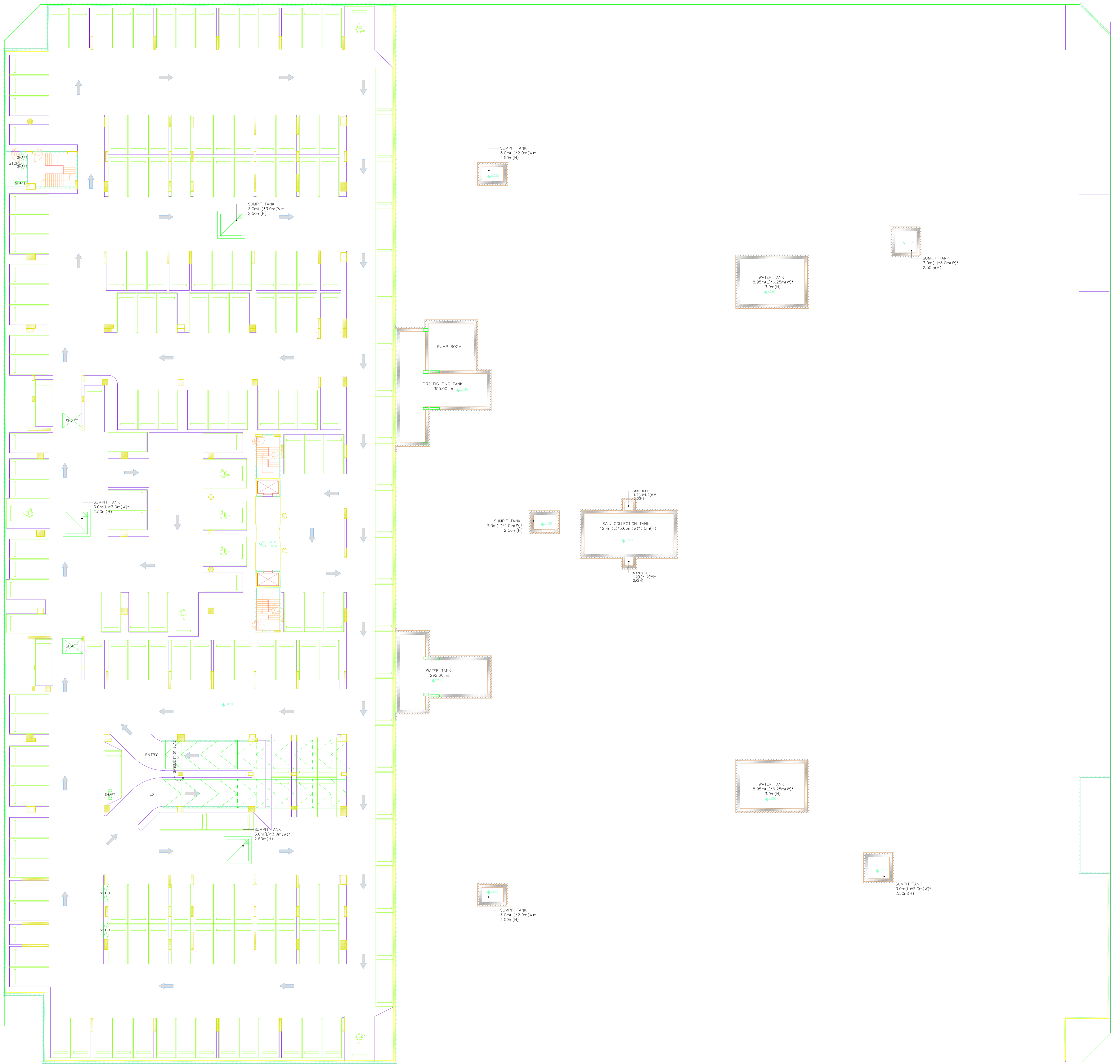

**TOWN CENTER PROJECT
BASEMENT-2**

TOTAL NO. OF PARKING = 826

**LOFT REAL ESTATE
MOB : +966552419045
Email: m.ali@loft.com.sa**





**TOWN CENTER PROJECT
BASEMENT-1**

TOTAL NO. OF PARKING = 826

**LOFT REAL ESTATE
MOB : +966552419045
Email: m.ali@loft.com.sa**

